

# SCALE SPRING SUPPORT NEWALL

## Installation Guide

This support is for applications where the reader head is the moving member, and the scale tube is stationary

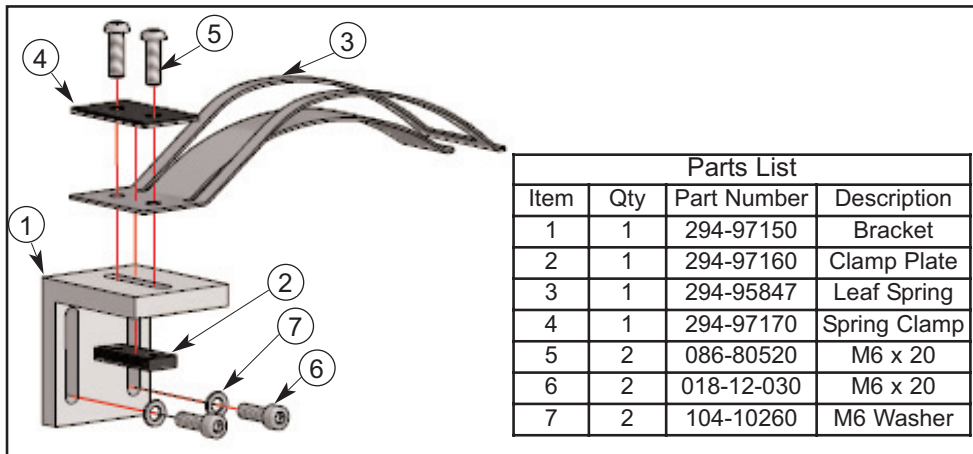
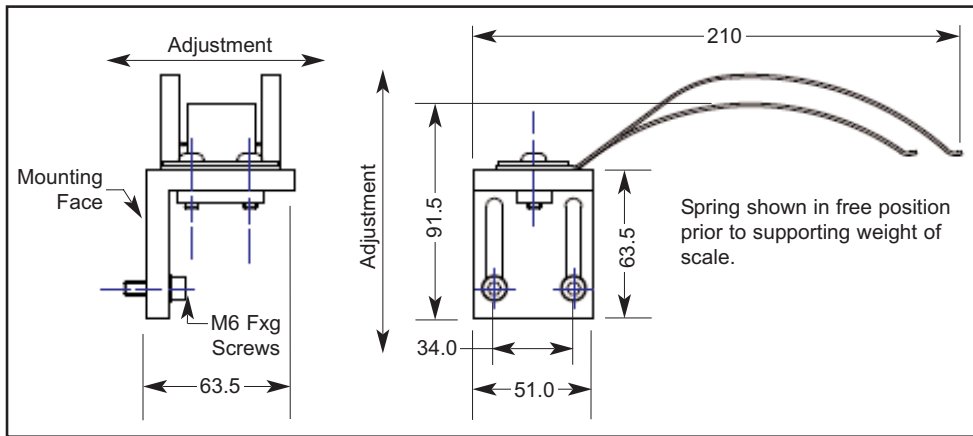

### HEAD OFFICE

**Newall Measurement Systems Ltd.**  
 Technology Gateway, Cornwall Road  
 South Wigston  
 Leicester LE18 4XH  
 United Kingdom  
 Telephone: +44 (0)116 264 2730  
 Facsimile: +44 (0)116 264 2731  
 Email: sales@newall.co.uk  
 Web: http://newall.com

### Newall Electronics, Inc.

1778 Dividend Drive  
 Columbus, OH 43228  
 Telephone: +1 614 771 0213  
 Toll Free: 800.229.4376  
 Facsimile: +1 614 771 0219  
 Email: sales@newall.com  
 Web: http://newall.com

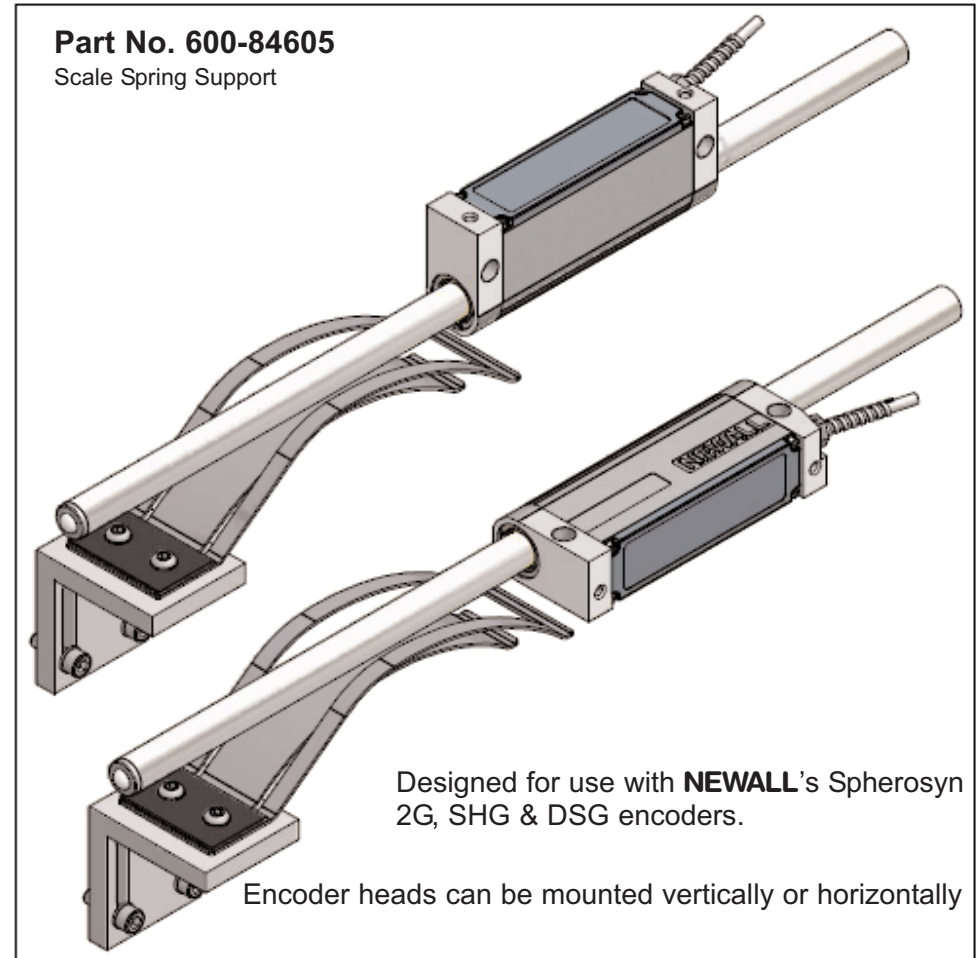

A brand of  
**CST**  
 CUSTOM SPINDLES & TECHNIQUE  
 023-81460/0

A full hard copy of the manual is available free of charge on request

# PROCEDURE

**STEP 1**

± 0.005mm (0.002")

Long scale mount and clamp

Encoder head can be installed vertically or horizontally

Install and align reader head and scale end brackets as described in the installation manual

**STEP 2**

Brackets

Install 600-84605 spring support assemblies.  
 Supports should be positioned along the length of the scale and spaced in increments of  $X=1.5\text{m}$  max.  
 Between 2.5 & 3.0m scale overall lengths use 1 off support.  
 Between 3.0 & 4.5m scale overall lengths use 2 off supports.  
 For longer lengths use an additional support for every 1.5m added.

**STEP 3**

Move head close to 600-84605 support.  
 Adjust height so that it is slightly higher than the top of the scale tube hole in the head.

**STEP 4**

Equal clearance each side

Insert scale tube.  
 Move head close to support.

Use a gauge to set scale tube destination height.

**STEP 5**

Move head past and close to the next support.

**STEP 6**

Repeat steps 3-6 for all remaining supports

**Notes:**

Correct assembly and height setting of the supports is essential to eliminate the possibility of scales becoming bent, inaccurate measurements and potential wear to encoder head and supports.

See rear page for dimensional details and component parts.